

ZH Telecody+ (电子密码器)

产品编号S11385

技术参数	
射频	868.30 MHz (SOMloq2)
温度范围	-20 °C ...+55 °C
无线电指令	12 种 (10 种带授权码，2 种不带授权码)
作用范围	50 m
防护等级	IP 64
尺寸 (外壳)	147 x 44 x 30 mm
重量	180g, 含电池
电池	CR123A 型 (3V)

概念	
无线电指令	无线电指令由 Telecody+ 在输入有效的授权码后发送。
授权码	在键盘上输入数字或数字序列 (0 ...9)。
激活时间	通过按下任意数字按钮重新发送之前发送的无线电指令的时间

使用范围/用途

- 适用于 Somloq 滚动码和 Somloq2 无线电系统。

复位代码标签

将带复位代码的标签妥善保管。例如在忘记授权码时，需要复位代码才能删除所有已编程的授权码。

功能说明

- 在输入正确的授权码后，Telecody+ 向接收器发送一种无线电指令。

- 如果 SOMloq2 是无线电接收器，则确认接收无线电指令且 Telecody+ LED 1 亮起。

安全提示

- 安装、运行或维护无线遥控的人员必须阅读、理解和遵守本说明书。

- 仅可由制造商授权的专业人员维修损坏的设备。
- 仅允许在直接可见的情况下对具有事故风险的设备进行遥控！
- 为保障设备运行安全，必须遵守当地现行的安全规定！
- VDE、职业联合会或其他国家类似机构可提供有关安全运行的相关信息。
- 严禁用输水软管或高压清洁机喷洗无线遥控器。水可能渗入，并损坏或毁坏无线电遥控器。

按规定使用

- 禁止遥控具有较高事故风险的设备和装置（比如起重设备）！
- 仅可在其发射器或接收器产生的无线电不会危及人身、动物或财产安全，或者通过其它安全设备消除此类危险的装置和设备上使用遥控。
- 对于来自其它电信设备或装置（例如：在相同频率范围中运行的、符合规定的无线电设备）的干扰，运营方无法加以避免。

显示和按钮说明

光显示

LED 1 (1)	<ul style="list-style-type: none">• 在发送一种无线指令时短时间亮起橙色• 当从 SOMloq2 无线接收器收到一条反馈信号时，亮起绿色 1 秒• 发送期间电池电量不足时闪烁红色
LED 2 (2)	<ul style="list-style-type: none">• 在短暂敲击键盘时亮起橙色• 闪烁：<ul style="list-style-type: none">- 复位 - 讯息- 激活时间- 发送延迟• 在 Telecody+ 锁定期间敲击键盘时短暂闪烁
LED (1) + (2)	<ul style="list-style-type: none">• 在以下情况下亮起 2 秒：<ul style="list-style-type: none">- 对授权码编程- 删除所有授权码- 打开/关闭激活时间

按钮	
数字 0 - 9	• 输入授权码
ESC	修正错误的输入内容 <ul style="list-style-type: none">• 结束激活时间• 中断输入• 关闭键盘灯
M	保存按钮 <ul style="list-style-type: none">• 打开或关闭激活时间• 复位至出厂设置 (与 P 按钮组合使用)
•	点按钮 <ul style="list-style-type: none">• 发送未编码的无线电指令• 打开键盘灯
○	圆圈按钮 <ul style="list-style-type: none">• 发送未编码的无线电指令• 打开键盘灯

无线电指令

Telecody+ 可直接通过按下按钮发送 12 种无线电指令。其中有 10 种无线电指令（数字 0 - 9）可进行编码。

指令	按钮	指令	按钮
1	1	7	7
2	2	8	8
3	3	9	9
4	4	10	0
5	5	11	•
6	6	12	○

接通

交付时已断开 Telecody+。首调前必须接通。

1. 按下并按住按钮 M。
 - LED 2 闪烁 3 次。
 - 之后，LED 1 + 2 亮起两秒。
 - 如此即可打开背景灯。

在接收器上示教

无线接收器进入示教模式的正确操作方法，以及接收器上的 LED 灯在不同示教阶段的相应反应，请参考接收器或驱动装置的说明书。

1. 接收器进入示教模式。
2. 输入所需的无线电指令/授权码
 - 可使用按钮 0 - 9 以及 •○。

提示！

按钮 •○ 仅用于发送不带授权码的无线电指令。它们无法配备授权码！

编程授权码

授权码由 2 部分组成，最多有 8 位。

第 1 部分 (第 1 位)	所需的无线电指令必须与授权码一起输入
第 2 部分 (第 2 - 8 位)	所需的授权码 (可自由选择)

无线电指令 1 的授权码示例

1 8 3 5

1. 按下按钮 P。
2. 按下按钮 1。
3. 重新按下按钮 P。
 - 已选择无线电指令 1。
4. 输入授权码的第 1 部分：
 - 按下按钮 1。
 - 第 1 部分的输入结束。
5. 输入授权码的第 2 部分：
 - 按下按钮 8。
 - 按下按钮 3。
 - 按下按钮 5。
 - 按下按钮 P。
 - 第 2 部分的输入结束。
 - LED 1 + 2 亮起 2 秒。
 - 无线电指令 1 的授权码现在是：1835
6. 输入授权码 1835 进行检查。
 - LED 2 短暂亮起。
 - LED 1 亮起绿色，作为无线接收器接收到指令的反馈 (针对 SOMloq2)。
 - 授权码已成功编程。

更改授权码

示例：将上述授权码 1835 改为 194686

1. 按下按钮 P。
2. 输入旧的授权码：1835。
3. 重新按下按钮 P。
4. 输入授权码的第 1 部分：
 - 按下按钮 1。
 - 第 1 部分的输入结束。
5. 输入授权码的第 2 部分：
 - 按下按钮 9
 - 按下按钮 4
 - 按下按钮 6
 - 按下按钮 8
 - 按下按钮 6
 - 按下按钮 P。
 - 第 2 部分的输入结束。
 - LED 1 + 2 亮起 2 秒。
 - 无线电指令 1 的授权码现在是：194686。
6. 输入授权码 194686 进行检查。
 - LED 2 短暂亮起
 - LED 1 亮起绿色，作为无线接收器接收到指令的反馈 (针对 SOMloq2)。
 - 授权码已成功编程。

从无线电指令中删除授权码

若例如无线电指令 3 受一个授权码保护，且之后无需授权码仍可使用：

1. 按下按钮 P。
2. 输入旧的授权码。
3. 重新按下按钮 P。
4. 输入授权码的第 1 部分：
 - 按下按钮 3。
5. 按下按钮 P。
 - LED 1 + 2 亮起 2 秒。
 - 之后只按下按钮 3 即可发送无线电命令，无需授权码。

复位至出厂设置

提示！

此时将删除所有已编程的授权码。Telecody+ 保持接通。

1. 按下按钮 M。
2. 按下按钮 P。
3. 输入 9 位复位代码 (见标签)。
4. 重新按下按钮 M。
5. 重新按下按钮 P。
 - LED 1 + 2 亮起橙色 2 秒。

运行

前提条件

- Telecody+ 已接通。
- 在所需的无线接收器上已示教 Telecody+

- 授权码已编程。
- Telecody+ 的电池电量充足。

通过输入有效的授权码或按下按钮 • 或 ○，将无线电指令发送至已示教的接收器，从而例如打开或关闭车库门。

- 发送无线电指令期间，LED 1 亮起 2 秒。
- LED 1 亮起绿色，作为无线接收器接收到指令的反馈 (针对 SOMloq2)。

激活时间

供货状态：已关闭。

描述

1. 在激活时间 (持续 20 秒) 期间，按下任意一个数字按钮。
 - 将发送之前输入的授权码
 - 激活时间再次开始 10 秒。

打开/关闭

1. 按下按钮 M。
2. 按下按钮 •。
3. 按下按钮 M。
 - 激活时间已打开或关闭

状态查询

可查询激活时间是否已打开：

1. 输入有效的授权码。
 - 正在发送无线指令
 - LED 1 亮起。
 - LED 2 闪烁 20 秒。

发送延迟

供货状态：已关闭。

无线电指令延迟发送 1 - 9 秒。设置范围 0 - 9 (0 = 无发送延迟)。发送延迟适用于所有无线电指令。

打开/关闭

1. 按下按钮 M。
2. 按下按钮 ○。
3. 通过数字键盘输入所需的延迟时长 (1 - 9 秒)。
4. 按下按钮 M
 - LED 1 + 2 亮起橙色 2 秒。

更换电池

如果电池电量较低，则在发送指令时，LED 1 将闪烁红色。

警告提示

- 禁止儿童触及电池。误吞咽时须立即就医！
 - 不得撬开电池，不得进行充电，不得接触水、明火或高温！
 - 更换时仅可使用 CR 123A 型 (3V) 电池！
 - 按照有效的国家规定对电池进行废弃处理！
1. 拔下螺栓盖 (3)。
 2. 旋出螺栓 (4)。
 3. 旋转 Telecody+，同样旋出下方的螺栓 (5)。
 4. 拔下外壳下部件。
 5. 更换电池 (6)。

按相反的顺序组装。

废弃处理

遵守相关的国家规定。

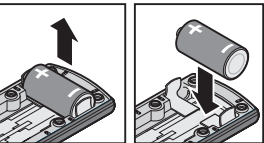
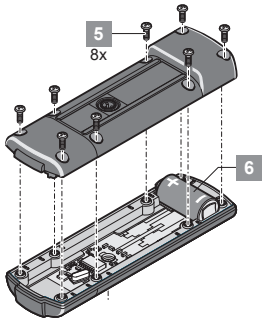
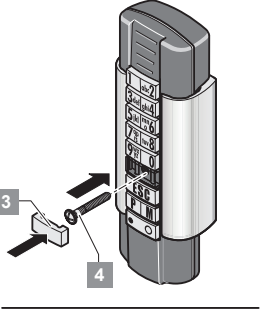
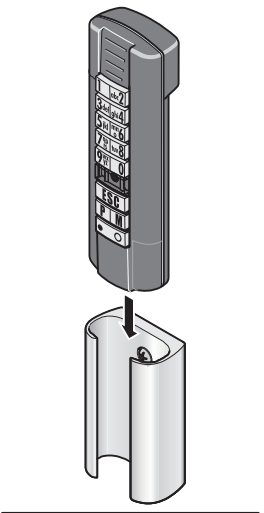
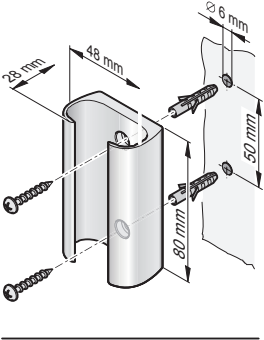
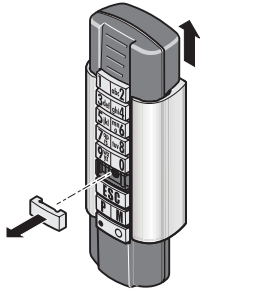
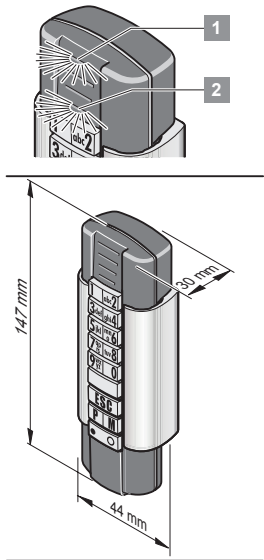

EN Telecody+

Article no. S11385

Technical data

Radio frequency	868.30 MHz (SOMloq2)
Temperature range	-20 °C ...+55 °C
Radio commands	12 (10 with access code, 2 without)
Range	50 m
IP code	IP 64
Dimensions (housing)	147 x 44 x 30 mm
Weight	180g incl. batteries
Battery	CR123A (3V)

Terms

Radio command	The Telecody+ sends the radio command after input of a valid access code.
Access code	Input of a number or number sequence (0 ...9) on the keypad.
Active time	Time during which the previously sent radio command is sent again by pressing any button.

Area for use / purpose

- Suitable for Somloq Rollingcode and SOMloq2 radio systems.

Reset code sticker

Keep the sticker with the reset code in a safe place. The reset code is required to delete all programmed access codes, e.g. if the access code has been forgotten.

Functional description

- The Telecody+ sends a radio command to a receiver after input of the correct access code.
- If the receiver is also a SOMloq2 radio receiver, the receipt of the radio command is confirmed and LED 1 on the Telecody+ lights.

Safety instructions

- These instructions must be read, understood and complied with by persons who install, use or perform maintenance on the radio remote control.

- Have faulty devices repaired by a technician authorised by the manufacturer.
- Systems that pose an accident risk should not be operated by remote control unless the complete range of movement of the system is visible to the user.
- The local safety regulations for the system must be observed to ensure safe operation.
- For information on safe operation see, e.g., VDE and employer's liability insurance associations or similar organisations in other countries.
- The radio remote control must never be sprayed with a water hose or high-pressure washer. External voltage can trigger severe power surges and damage or destroy the radio remote control.

Intended use

- Remote control of devices and systems with increased accident risk (e.g. hoists) is prohibited.
- The remote control must only be used for devices and systems in which radio interference in the transmitter or receiver will not endanger people, animals or objects, or the risk is reduced by other safety devices.
- The operator is not protected against interference caused by other telecommunications equipment or devices (e.g. wireless systems which are being operated properly in the same frequency range).

Display and button explanation

Optical display

LED 1 (1)	<ul style="list-style-type: none">• Briefly lights orange when a radio command is sent• Lights green for 1 second if a response from a SOMloq2 radio receiver has been received• Flashes red during transmission if the battery charge is low
LED 2 (2)	<ul style="list-style-type: none">• Lights briefly orange during button inputs• Flashes for:<ul style="list-style-type: none">- Reset message- Active time- Transmission delay• Flashes briefly during button input when the Telecody+ is locked
LED (1) + (2)	<ul style="list-style-type: none">• Light for 2 seconds while:<ul style="list-style-type: none">- Programming an access code- Deleting all access codes- Switching active time on/off

Buttons

Numbers 0 - 9	• Input of access codes
ESC	Correction of an incorrect input <ul style="list-style-type: none">• Stop active time• Cancel input• Switch off keypad light
M	Memory button <ul style="list-style-type: none">• Switching active time on or off• Reset to factory settings (in combination with P button)
•	Dot button <ul style="list-style-type: none">• Send uncoded radio command• Switch on keypad light
○	Round button <ul style="list-style-type: none">• Send uncoded radio command• Switch on keypad light

Radio commands

The Telecody+ can send 12 radio commands directly by pressing a button. 10 commands (numbers 0 - 9) can be coded.

Command	Button	Command	Button
1	1	7	7
2	2	8	8
3	3	9	9
4	4	10	0
5	5	11	•
6	6	12	○

Switch on

The Telecody+ is disabled on delivery. It must be enabled before initial commissioning.

1. Press and hold button (M).
 - LED 2 flashes three times.
 - Then LED 1 + 2 light for two seconds.
 - Backlighting is switched on.

Programming to transmitter

See the instructions for the receiver or the operator for the correct procedure for setting the radio receiver in programming mode and the correct response of the LED on the receiver at the various phases of the programming process.

1. Set receiver in programming mode.
2. Enter the desired radio command or access code
 - Buttons 0 - 9 and •○ can be used.

NOTE!

The •○ buttons are for sending a radio command without access code. They cannot be programmed with an access code.

Programming access code

An access code consists of 2 parts with a total of 8 characters.

Part 1 (character 1)	desired radio command must be input every time the access code is input
Part 2 (character 2 - 8)	desired access code (freely selectable)

Example of access code for radio command 1
1 8 3 5

1. Press button P.
2. Press button 1.
3. Press button P again.
 - Radio command 1 is selected.
4. Input part 1 of the access code:
 - Press button 1.
 - Input of part 1 complete.
5. Input part 2 of the access code:
 - Press button 8.
 - Press button 3.
 - Press button 5.
 - Press button P.
 - Input of part 2 complete.
 - LED 1 + 2 light for 2 seconds.
 - The access code for radio command 1 is now: **1835**
6. Input **1835** to check the access code.
 - LED 2 lights briefly.
 - LED 1 lights green to acknowledge that the command was received by the radio receiver (for SOMloq2).
 - Access code successfully programmed

Changing access code

Example: Above access code **1835** changed to **194686**

1. Press button P.
2. Input old access code: **1835**
3. Press button P again.
4. Input part 1 of the access code:
 - Press button 1.
 - Input of part 1 complete.
5. Input part 2 of the access code:
 - Press button 9
 - Press button 4
 - Press button 6
 - Press button 8
 - Press button 6
 - Press button P.
 - Input of part 2 complete.

- LED 1 + 2 light for 2 seconds.
- The access code for radio command 1 is now: **194686**.

6. Input **194686** to check the access code.
 - LED 2 lights briefly
 - LED 1 lights green to acknowledge that the command was received by the radio receiver (for SOMloq2).
 - Access code successfully programmed

Deleting access code from radio command

For example, if radio command 3 is protected by an access code and is to be used in future without code:

1. Press button P.
2. Input old access code.
3. Press button P again.
4. Input part 1 of the access code:
 - Press button 3.
5. Press button P.
 - LED 1 + 2 light for 2 seconds.
 - Radio command will now be sent by pressing button 3 alone without requiring an access code.

Reset to factory settings

NOTE!

This will delete all programmed access codes. The Telecody+ remains activated.

1. Press button M.
2. Press button P.
3. Input 9-digit reset code (see sticker)
4. Press button M again.
5. Press button P again.
 - LED 1+ 2 light orange for 2 seconds.

Operation

Requirements

- Telecody+ activated.
- Telecody+ programmed to the required radio receiver
- Access code/access codes programmed
- Telecody+ battery is not flat.

Input of a valid access code or pressing the • or ○ button sends a radio command to the programmed receiver, which for example opens or closes a garage door.

- During transmission of a radio command LED 1 lights for 2 seconds.
- LED 1 lights green to acknowledge that the command was received by the radio receiver (for SOMloq2).

Active time

Delivery status deactivated.

Description

1. During the activated period (lasts for 20 seconds) press any button except P, M, ESC.
 - The previously input access code is sent
 - The activated time is restarted for 10 seconds.

Activate/deactivate

1. Press button M.
2. Press • button.
3. Press button M.
 - Active time switched on or off

Status query

The user can check whether the active time is activated:

1. Input valid access code.
 - Radio command is sent
 - LED 1 on.
 - LED 2 flashes for 20 seconds.

Transmission delay

Delivery status deactivated.

The radio command is sent with a delay of 1 - 9 seconds. Setting range 0 - 9 (0 = no transmission delay). The transmission delay is applicable for all radio commands.

Activate/deactivate

1. Press button M.
2. Press ○ button.
3. Input the desired transmission delay on the keypad (1 - 9 s).
4. Press button M.
 - LED 1 + 2 light orange for 2 seconds.

Replace battery

If the charge of a battery is low, LED 1 flashes red when a command is sent.

Warning information

- Never leave batteries within reach of children. Call a doctor immediately if a battery is swallowed.
 - Do not open or recharge the battery or allow it to come into contact with water, fire or high temperatures.
 - Replace battery only with CR 123A (3V).
 - Dispose of the battery according to locally applicable regulations.
1. Pull off screw cover (3).
 2. Unscrew screw (4).
 3. Rotate Telecody+ and unscrew the bottom screws (5).
 4. Lift bottom section of housing.
 5. Replace the battery (6).

Proceed in reverse order to reassemble.

Disposal

Observe applicable national regulations.