

EN TRANSLATION OF THE ORIGINAL INSTALLATION AND OPERATING MANUAL

DoorScout

Information on the operator:

Serial No.: See the title page of the installation and operating manual (if applicable warranty label).

Year of manufacture: from 05.2018

Information on the Installation and Operating Manual

Version of the installation and operating manual:

DoorScout_S10763-00001_482021_0-DRE_Rev-D_EN

Warranty

The warranty complies with statutory requirements. The contact person for warranties is the qualified dealer. The warranty is only valid in the country in which the operator was purchased. There is no warranty for consumables such as batteries, accumulators and safety products as well as light bulbs. This also applies for wear parts.

Contact data

If you require after-sales service, spare parts or accessories, please contact your qualified specialist retailer or installer.

Feedback on this Installation and Operating Manual

We have tried to make the Installation and Operating Manual as easy as possible to follow. If you have any suggestions as to how we could improve it or if you think more information is needed, please send your suggestions to us:



+49 (0) 7021 8001-403



doku@sommer.eu

Service

If you require service, please contact your specialist retailer, our service hotline (fee required) or see our web site:



+49 (0) 900 1800-150

(0.14 euros/minute from land line telephones in Germany, mobile prices may vary)

www.sommer.eu/de/kundendienst.html

Copyright and proprietary rights

The manufacturer retains the copyright for this Installation and Operating manual. No part of this installation and operating manual may be reproduced in any form without the written permission of **SOMMER Antriebs- und Funktechnik GmbH** or processed, copied, or distributed using electronic systems. Violations of the above stipulations will lead to damage claims. All brands mentioned in this manual are the property of their respective manufacturer and hereby recognised as such.

Table of contents

Table of contents	3
1. About this Installation and Operating Manual	4
1.1 Storage and circulation of the Installation and Operating Manual	4
1.2 Important for translations	4
1.3 Description of the product type	4
1.4 Target groups of the Installation and Operating Manual	4
1.5 Intended use	4
1.6 Declaration of Conformity	4
2. General safety instructions	5
3. Scope of delivery	6
4. Installation	7
4.1 Installation position of the transmitter on sliding gates	7
4.2 Installation position of the transmitter on roller doors	7
5. Connecting the transmitter	8
5.1 Connecting an 8k2 strip	8
5.2 Connecting an optical safety contact strip (OSE)	9
6. Connecting the receiver	10
6.1 Connecting to operator control unit ST-B-1	10
6.2 Connecting to operator control unit RT-E-1 (RDC Vision+)	10
7. Initial operation	11
7.1 Checking the mode	11
7.2 Changing the mode	11
7.3 Resetting the operator to factory settings	12
7.4 Resetting the radio receiver	12
7.5 DIP switch settings	12
7.6 Programming transmitter to receiver	13
7.7 Reprogramming the operator / resetting the run time	13
7.8 Final and safety tests	13

1. About this Installation and Operating Manual

1.1 Storage and circulation of the Installation and Operating Manual

Read this Installation and Operating Manual carefully and completely before installation, commissioning and operation and also before removal. Follow all warnings and safety instructions.

Keep this Installation and Operating Manual accessible at all times at the place of use.

A replacement for the installation and operating manual can be downloaded from **SOMMER Antriebs- und Funktechnik GmbH** at:

www.sommer.eu

During the transfer or resale of the product to third parties, the following documents must be passed on to the new operator:

- this Installation and Operating Manual
- documents recording retrofitting and repairs
- proof of regular care, maintenance and testing
- Declaration of Conformity and Handover Report

1.2 Important for translations

This original Installation and Operating Manual was written in German. The other available languages are translations of the German version. You can get the original Installation and Operating Manual by scanning the QR code:



<http://som4.me/orig-doorscout-revc>

For other language versions, see:



som4.me/man

1.3 Description of the product type

Evaluation unit for electrical safety contact strips for the protection of automated doors. Signals are transmitted via radio. It has been constructed according to state-of-the-art technology and recognised technical regulations.

1.4 Target groups of the Installation and Operating Manual

The installation and operating manual must be read and observed by everyone assigned with one of the following tasks or using the device:

- Installation
- Initial operation
- Settings
- Usage
- Care and maintenance
- Testing
- Troubleshooting
- Disassembly and disposal

1.5 Intended use

- The safety contact strip may only be used together with door operators from SOMMER Antriebs- und Funktechnik GmbH.
- The safety contact strip may only be used if it is in perfect condition.
- Any defects must be remedied without delay.

1.6 Declaration of Conformity

You can access the Declaration of Conformity for all radio technology products of SOMMER Antriebs- und Funktechnik GmbH by scanning the QR code below or via the URL shown beneath it.



som4.me/mrl

2. General safety instructions



DANGER

Danger due to electric current! Contact with live parts may result in electric current flowing through the body. Electric shock, burns, or death may result.

- ▶ Installation, testing and replacement of electrical components must be carried out by a **trained electrician**.
- ▶ Disconnect the mains plug of the operator before working on electrical components.
- ▶ Then check that the equipment is disconnected from the power supply and secure it against being switched on again.



DANGER

Danger caused by incorrect installation or incorrect handling! Incorrect installation / initial operation or incorrect handling of the safety contact strip may result in severe or even fatal injury.

- ▶ Installation, initial operation, repairs and maintenance must be carried by specialist personnel.
- ▶ The operator of the equipment must instruct all users on the safe handling of the door system.
- ▶ Children must never play with or use the door system, even under supervision.
- ▶ Keep children away from the door system.



WARNING

Danger caused by failure to observe safety instructions and warnings! The installation and operating manuals for the operator and the control unit contain further safety instructions and warnings important for safe handling of the door system.

- ▶ All safety instructions and warnings must be observed and complied with.



WARNING

Danger of hazardous substances! Improper storage, use or disposal of accumulators or batteries are dangerous for the health of humans and animals.

- ▶ Store batteries out of the reach of children and animals.
- ▶ Store and dispose of batteries correctly, in accordance with the manufacturer's instructions.
- ▶ Do not charge batteries.



NOTE

The DoorScout can only be used with the following operators and software versions

ST-B-1

- ▶ RUNner (V3.1)
- ▶ RUNner+ (V3.1)
- ▶ SP900 (V3.1)
- ▶ S900 (V3.1)

RT-E-1

- ▶ RDC Vision+

3. Scope of delivery

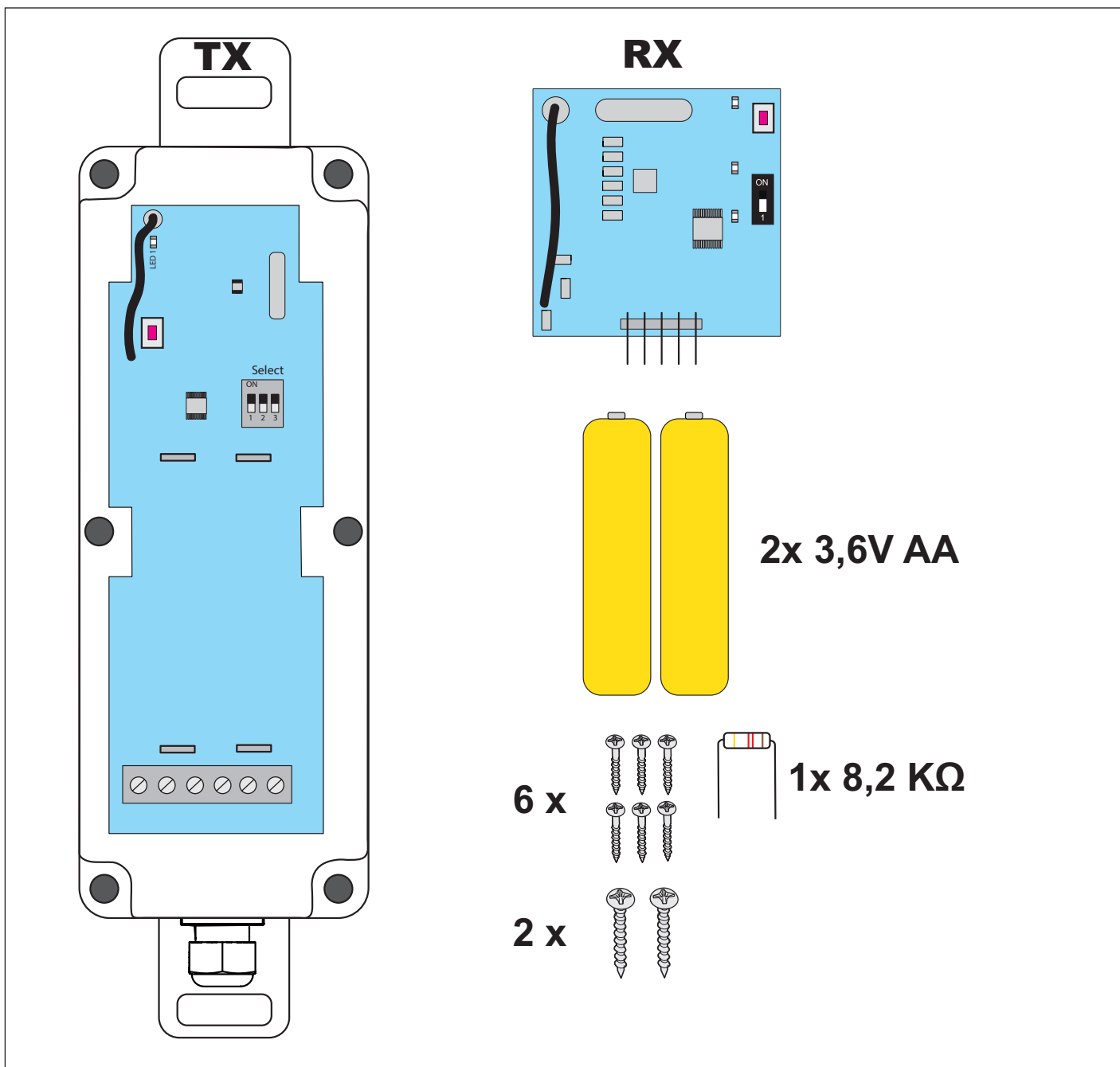

4. Installation

4.1 Installation position of the transmitter on sliding gates

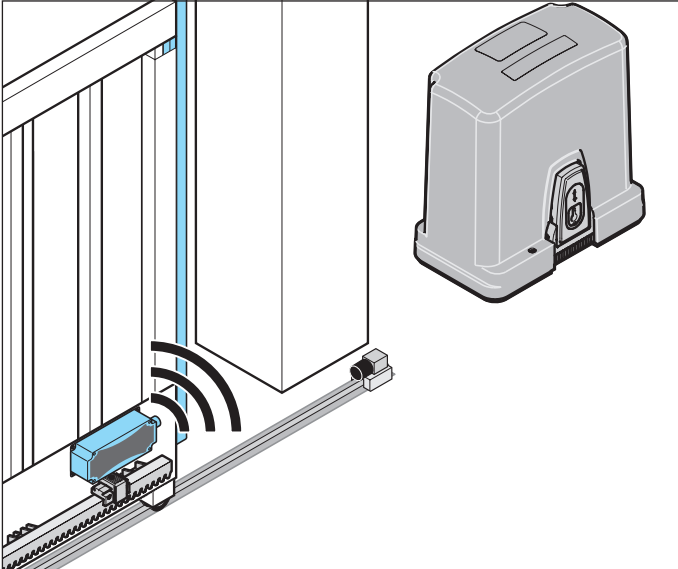

4.2 Installation position of the transmitter on roller doors

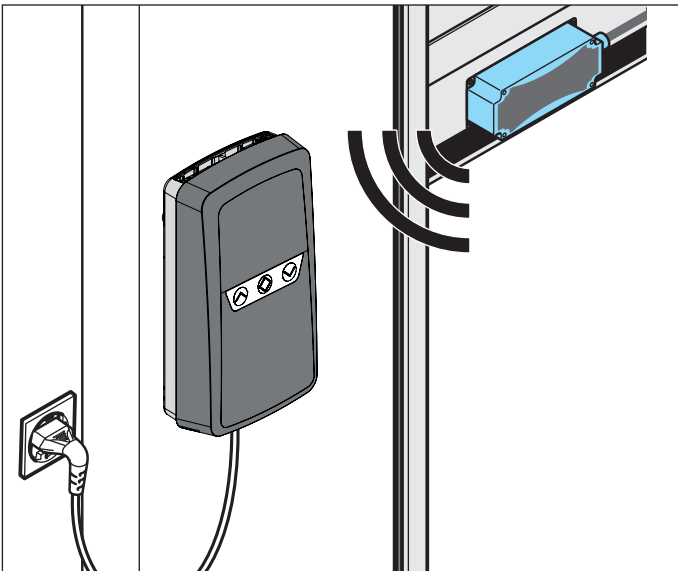

5. Connecting the transmitter



NOTE

- ▶ Safety contact strips for door - OPEN, door - CLOSE or both directions can be installed. Exception: Connection in door OPEN direction is not possible in the case of roller doors.
- ▶ If only one strip is attached, an 8k2 resistor must be connected between the unused terminals.
- ▶ The polarity is irrelevant when connecting 8k2 safety contact strips.

5.1 Connecting an 8k2 strip

Connecting safety contact strips for door - OPEN and door - CLOSE

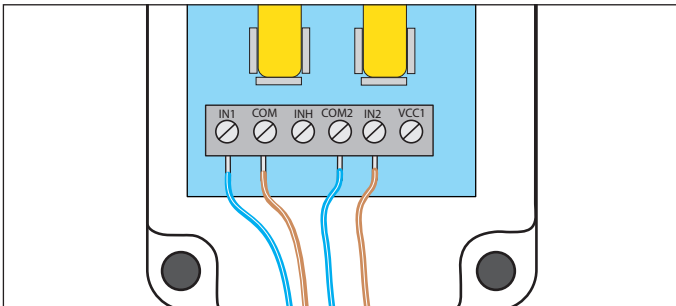

Terminal	Function
IN1	Door - OPEN
COM	
INH	-
COM2	Door - CLOSE
IN2	
VCC1	-

Connecting safety contact strips for door - OPEN

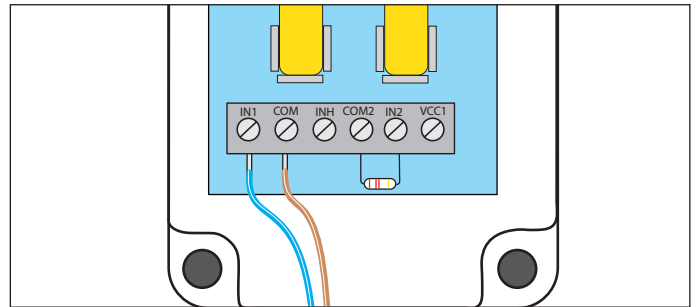

Terminal	Connected component
IN1	Door - OPEN
COM	
INH	-
COM2	8k2 resistor
IN2	
VCC1	-

Connecting safety contact strips for door - CLOSE

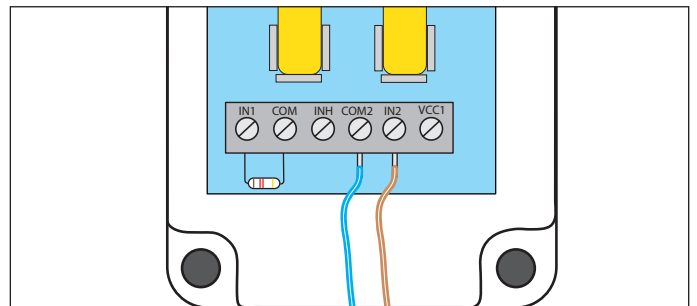

Terminal	Connected component
IN1	8k2 resistor
COM	
INH	-
COM2	Door - CLOSE
IN2	
VCC1	-

5. Connecting the transmitter

5.2 Connecting an optical safety contact strip (OSE)



NOTE

An OSE can only be connected in door CLOSE direction.

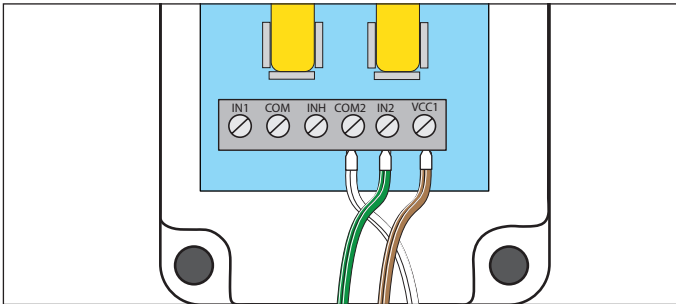

- Connect the optical safety contact strip to the DoorScout as shown in the diagram.

Terminal	Connected component
IN1	-
COM	-
INH	-
COM2	white
IN2	green
VCC1	brown

6. Connecting the receiver

6.1 Connecting to operator control unit ST-B-1



NOTE

The diagram shows an example of how the receiver is plugged into an operator control unit. See the respective installation and operating manual for the position of the slot on other door operators.

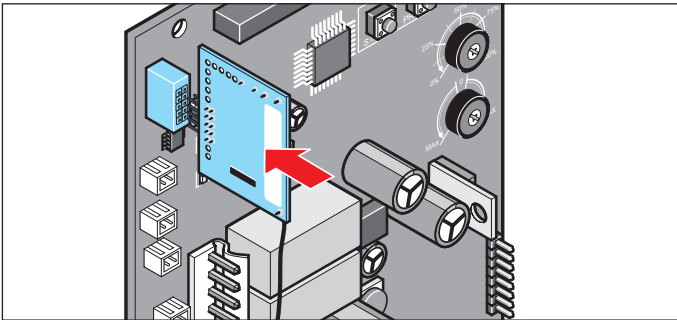

1. Turn off the voltage supply to the operator.
2. Fit the receiver (RX) onto the control unit.
3. Restore the voltage supply to the operator.

6.2 Connecting to operator control unit RT-E-1 (RDC Vision+)

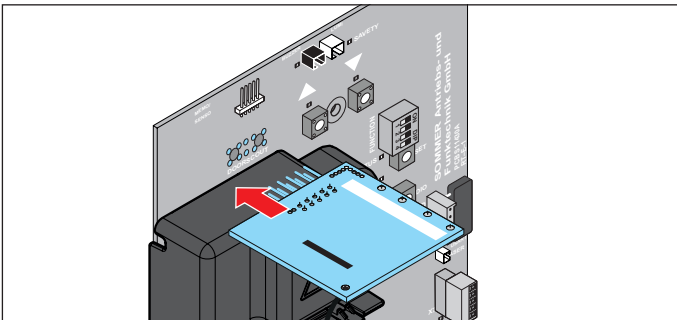

1. Turn off the control unit voltage supply.
2. Fit the receiver (RX) onto the control unit.
3. Restore the voltage supply to the control unit.

7. Initial operation

7.1 Checking the mode



NOTE

- ▶ 8k2 mode must be activated in order to operate the DoorScout with an 8k2 safety contact strip.
- ▶ OSE mode must be activated in order to operate the DoorScout with an optical safety contact strip.

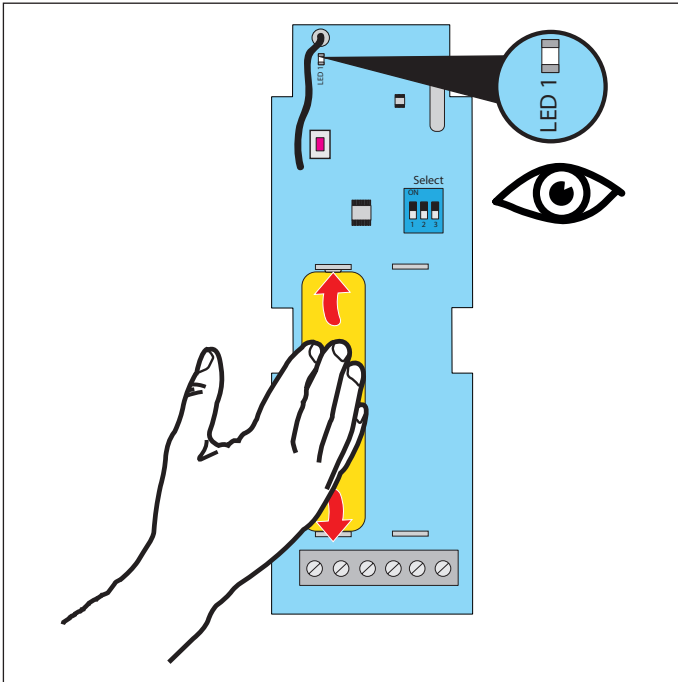

1. Insert left battery.
2. Observe the flash sequence.

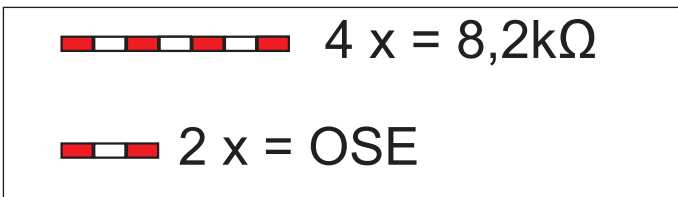

- ⇒ LED blinks 4 x = 8k2 mode
- ⇒ LED blinks 2 x = OSE mode

7.2 Changing the mode



NOTE

It is only necessary to carry out this step if the check described in "7.1 Checking the mode" shows that the desired mode is not activated.

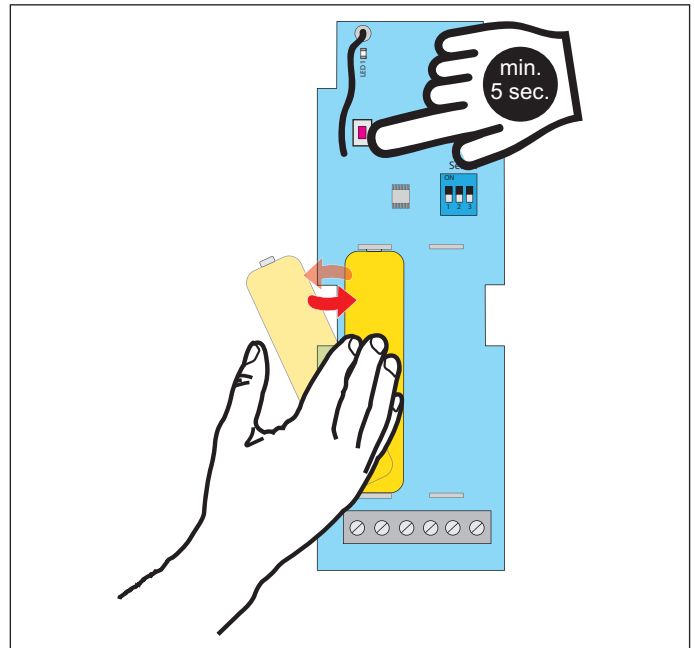

1. Remove left battery.
2. Insert the left battery again after approx. 5 seconds.
3. Press and hold the button as shown in the diagram for at least 5 seconds.
 - ⇒ Mode has been changed.
 - ⇒ If necessary, check the mode again.

7. Initial operation

7.3 Resetting the operator to factory settings



NOTE

- ▶ The second battery must be inserted before carrying out the following steps.
- ▶ The door operator must be reset to the factory settings before initial operation of the DoorScout.
- ▶ The procedure for carrying out a factory reset is described in detail in the installation and operating manual for the door operator:

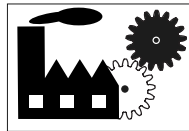

som4.me/man

7.4 Resetting the radio receiver



NOTE

The receiver (RX) must be completely deleted before the transmitter (TX) can be programmed.

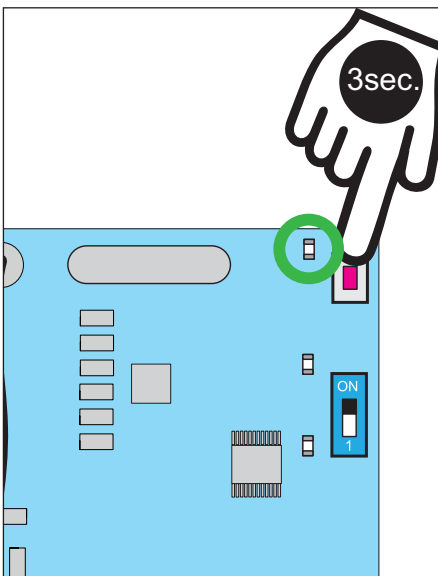

- Press and hold button on the receiver (RX) for 3 seconds.
 - ⇒ The LED blinks green several times.
 - ⇒ Then the LED lights up green for 10 seconds.

7.5 DIP switch settings

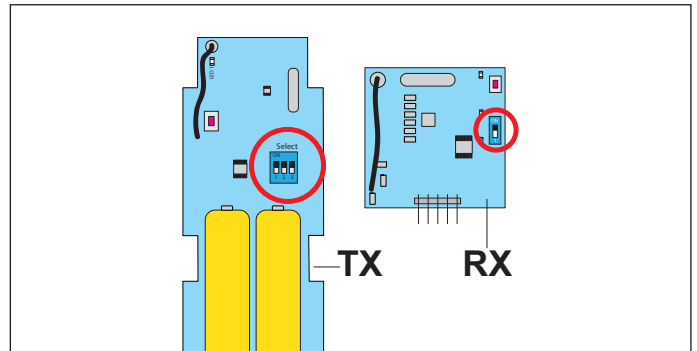

Selecting the radio frequency

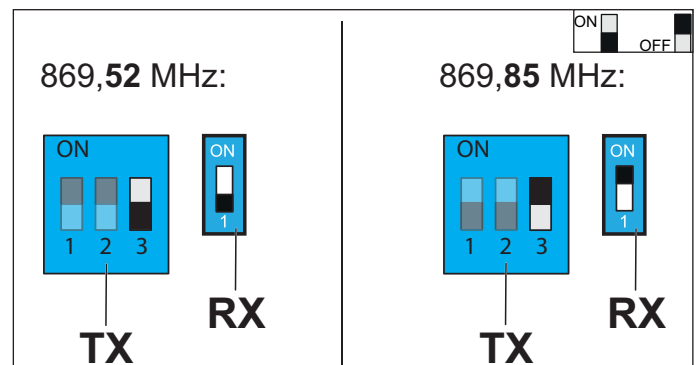

- Set the desired radio frequency via the DIP switches (see Fig.).*

869.52 MHz	Transmitter (TX)	3 ON
	Receiver (RX)	1 ON
869.85 MHz	Transmitter (TX)	3 OFF
	Receiver (RX)	1 OFF

* DIP switches 1 and 2 on the transmitter (TX) are not relevant for the radio frequency

7. Initial operation

Selecting the safety contact strip

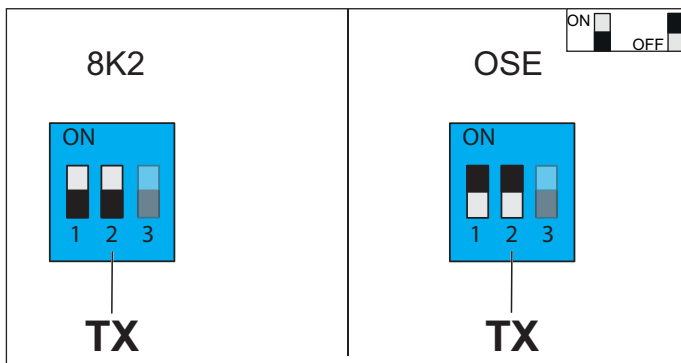

- Set the desired safety contact strip via the DIP switches (see Fig.).

8k2	Transmitter (TX)	1 + 2 ON
OSE	Transmitter (TX)	1 + 2 OFF

DIP switch 3 and (TX) is not relevant for selection of the safety contact strip.

7.6 Programming transmitter to receiver

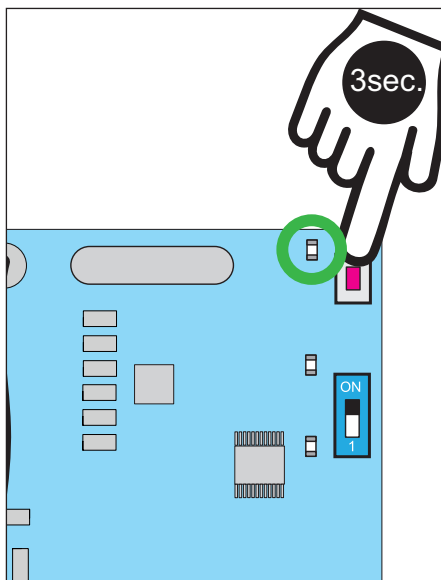

- Press and hold button on the receiver (RX) for 3 seconds.
 - ⇒ The LED blinks green several times.
 - ⇒ Then the LED lights up green for 10 seconds.

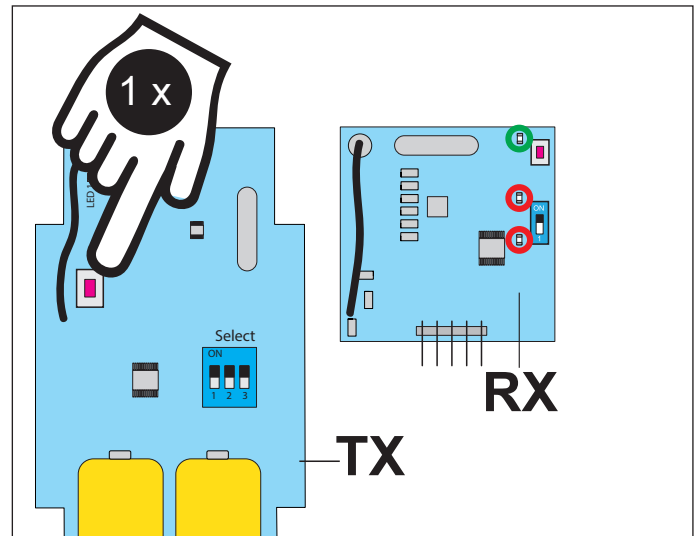

- Press button on transmitter circuit board (TX) 1x.
 - ⇒ Red LEDs on receiver circuit board (RX) light up.

7.7 Reprogramming the operator / resetting the run time

NOTE

- The programming procedure is described in detail in the installation and operating manual for the door operator or control unit:



som4.me/man

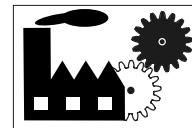

7.8 Final and safety tests

After completing initial operation, all connected safety devices must be tested for correct functioning.

The safety devices must be tested regularly (once a month).

SOMMER Antriebs- und Funktechnik GmbH

Hans-Böckler-Straße 21-27

73230 Kirchheim/Teck

Germany

Phone: +49 (0) 7021 8001-0

Fax: +49 (0) 7021 8001-100

info@sommer.eu

www.sommer.eu

© Copyright 2021 All rights reserved.