

# Checklist for sliding gate operators

## Gate leaf

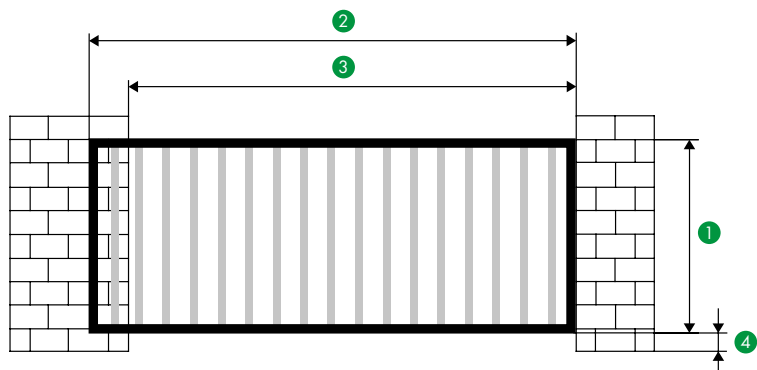

### Weight and sizes

- |   |                            |          |
|---|----------------------------|----------|
|   | Gate leaf weight           | _____ kg |
| ① | Gate leaf height           | _____ mm |
| ② | Gate leaf width            | _____ mm |
| ③ | Clearance                  | _____ mm |
| ④ | Ground-bottom edge of gate | _____ mm |
|   | Max. travel length         | _____ mm |

## Post situation

### Dimensioning

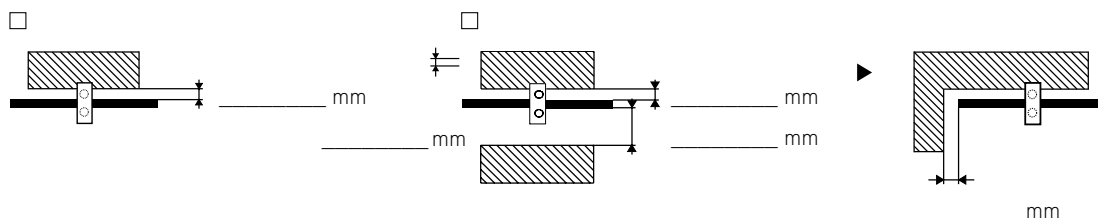

### Post situation from above (for calculation of the safety contact strips)

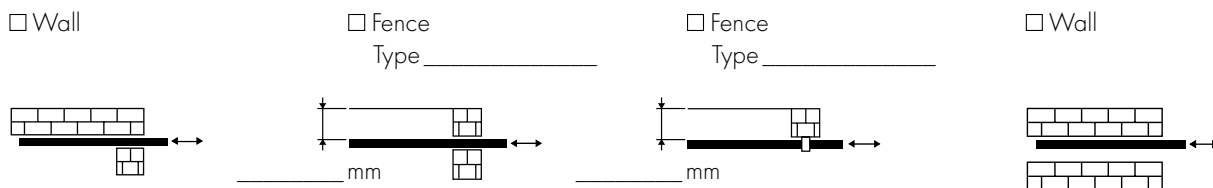

# Checklist for sliding gate operators

## Additional information

Does the door have an inclination?

- No  
 Yes, \_\_\_\_\_% (max. 5% inclination)

Does the door have a full surface closed infill?

- Yes  
 No, type \_\_\_\_\_

Power connection:

- 230 V  
 400 V

Opening operations per day:

\_\_\_\_\_

Opening operations per hour:

\_\_\_\_\_

Use of the gate:

- Private  
 Public/commercial

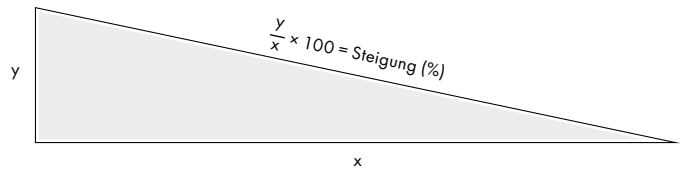

**Example for calculation of the inclination:**

$$x = 10 \text{ m} \quad y = 0.1 \text{ m}$$

$$0.1 \text{ m} / 10 \text{ m} \times 100 = 0.01 \times 100 = 1\% \text{ inclination}$$

## Mode of operation

- Pulse mode  
 Dead man mode (only possible without radio)  
 Automatic mode (only in combination with photocells)

## Accessories

### 1. Operation

- Handheld transmitter \_\_\_\_\_ pcs.  
 Key switch  
 flush-mounted  
 surface-mounted  
 Telecody+  
 Rod antenna
- Traffic light control (DS 600/DS 1200 only)  
 Access systems  
 Fingerprint (ENTRASys)

### 2. Safety

- Safety contact strip \_\_\_\_\_ pcs.  
 Photocell \_\_\_\_\_ pcs.  
 Warning light
- Main switch  
 Motor protection switch  
 Evaluation electronics for safety contact strip



It is important that the gate can be opened and closed easily by hand. The force requirement here is 150 N for private and 260 N for commercial use.



Simply fill in the checklist, enter your contact data and submit to SOMMER together with your inquiry (Fax: 07021/8001-100, e-mail: info@sommer.eu).  
You can download the checklist at [www.som4.me/chkl](http://www.som4.me/chkl).  
You can find further information at [www.som4.me/man-s](http://www.som4.me/man-s).

Company stamp / customer number \_\_\_\_\_  
(The customer number is required for processing.)